

PEACE OF MIND THAT SAMPLES ARE SAFE

SenseAnywhere | Monitor and audit safe storage



With SenseAnywhere, it's easier than ever to know specimens are safe, whether in the lab or at remote sites.

SenseAnywhere is a cloud-based tool that allows users to monitor and audit the safe storage of valuable biological specimens remotely — from anywhere in the world — with just an internet connection.

SenseAnywhere combines wireless sensors and the power of the cloud to track cryogenic temperatures across a few units or an entire fleet.



Why SenseAnywhere?

- Connect and monitor multiple units. Users can connect any number of freezers to view performance data from multiple cryogenic units from one location on any device.
- Maintain compliance. Users will have a record of temperature performance to support regulatory compliance.
- Secure data. Automatic data uploads (via site Ethernet or cellular GSM) and an independent system for redundancy maintains data safely.
- Instant notifications. Users can choose to receive customized text or email alarm notifications and alerts, so they'll know the moment their cryogenic freezers dip below temperature thresholds, liquid levels, or the door is opened.
- Minimize IT roadblocks. SenseAnywhere is easy to set up and rarely requires IT support.
- Large temperature display. A large home screen (on any device with a web browser connected to the cloud) makes it easy to see temperature information at a glance. Customers can view ambient temperatures, freezer temperatures, temperature history and alarm details.
- Monitor other lab equipment. SenseAnywhere doesn't just work with Custom Biogenic Systems' cryogenic freezers. Customers can monitor temperatures and receive alerts from other lab equipment types and manufacturers.

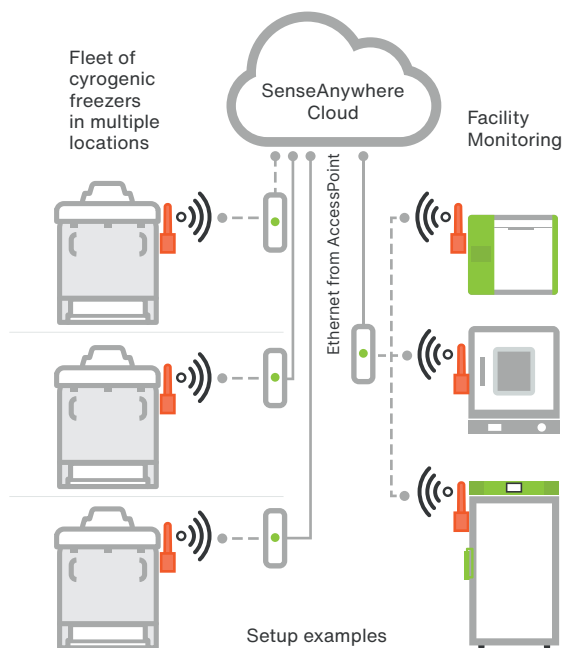

STEP 1 Configure the best SenseAnywhere

It's easy to configure the best SenseAnywhere solutions for your customers.

Identify the stationary environment that needs to be monitored.

- Stationary monitoring utilizes the Indoor AccessPoint.

Layout a floor plan that shows the monitoring locations.

- This helps determine the number of AccessPoints required.
- Indoor AccessPoints can communicate up to 600 meters line of sight.
- Doors, walls and liquids may diminish the distance of communication.

Plan Details

Text/SMS	Unlimited
E-mail/Cloud access	Yes
Temperature data storage period	15 years
Max Sensors viewable in chart exports	100
Max users	Unlimited
Alarm profiles per Sensor	5
Reminder alerts	5
Credits per year, per Sensor	3

STEP 2 Determine your remote monitoring setup

Determining your remote monitoring setup on a cryogenic freezer is as easy as A-B-C.

A

Monitor cryogenic temperatures with the AiroSensor and PT100 temperature probe.

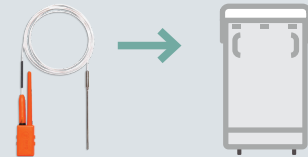

B

Monitor the liquid level with 0-10V or 4-20mA input.



C

Monitor door opening events with the dry contact alarm and door switch.



Contact a CBS representative at:

[Custombiogenics.com/products/isothermal-freezers](https://www.custombiogenics.com/products/isothermal-freezers)